

# STANDARD RANGE MORSE TAPER SHANK MULTIPLEX HOLDERS

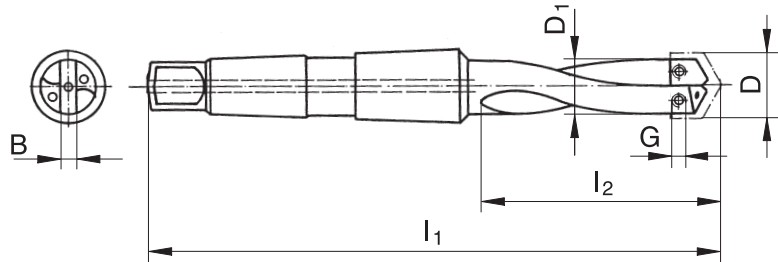
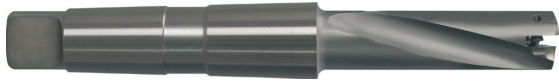

\*Attention: only for insert thickness 4 mm

## 86630 short, axial coolant delivery, radial coolant delivery on request

Hole Ø-range D mm	Total length I <sub>1</sub> mm	Flute length I <sub>2</sub> mm	Morse taper	Holder-Ø d <sub>1</sub> mm	Width of slot B mm	Torx screws <b>86807</b>		Screw driver size	Code no.
						Size	Code no.		
9.70 - 11.70	139	56	2	9.5	2.5	M 2x4	2.000	T 6	<b>09.500</b>
11.71 - 13.40	141	58	2	11.5	2.5	M 2x4	2.000	T 6	<b>11.500</b>
13.41 - 16.40	148	63	2	13.0	3.5	M 2.5x5	2.500	T 7	<b>13.000</b>
16.41 - 18.90	150	67	2	16.0	3.5	M 2.5x7	2.501	T 7	<b>16.000</b>
18.91 - 22.40	178	76	3	18.5	4.0	M 3x6	3.000	T 9	<b>18.500</b>
22.41 - 25.40*	181	80	3	22.0	4.0	M 3x8	3.001	T 9	<b>22.000</b>

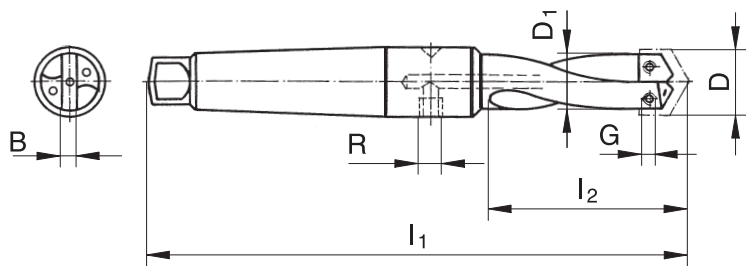

- holder ≥ Ø 63 mm straight fluted
- morse taper 5 for cotter retention
- \* insert thickness 5 mm

## 86670 short, radial coolant delivery, axial coolant delivery on request

Hole Ø-range D mm	Total length I <sub>1</sub> mm	Flute length I <sub>2</sub> mm	Morse taper	Holder-Ø d <sub>1</sub> mm	Width of slot B mm	R	Torx screws <b>86807</b>		Screw driver size	Code no.
							Size	Code no.		
25.01 - 29.00*	279	108	4	24	5	G 1/4"	M 3.5x10	3.500	T 15	<b>24.000</b>
29.01 - 35.00	279	108	4	28	5	G 1/4"	M 3.5x10	3.500	T 15	<b>28.000</b>
35.01 - 45.00	324	152	4	34	7	G 1/4"	M 4x15	4.001	T 20	<b>34.000</b>
45.01 - 55.00	324	152	4	44	7	G 1/4"	M 4x15	4.001	T 20	<b>44.000</b>
55.01 - 65.00	324	152	4	54	7	G 1/4"	M 4x15	4.001	T 20	<b>54.000</b>
65.01 - 78.00	436	216	5	63	9	G 1/2"	M 5x20	5.000	T 20	<b>63.000</b>
78.01 - 90.00	436	216	5	77	9	G 1/2"	M 5x20	5.000	T 20	<b>77.000</b>
90.01 - 102.00	436	216	5	89	9	G 1/2"	M 5x20	5.000	T 20	<b>89.000</b>